

PYROSWISS® SBS D 120 (Smoke Barrier System)

Static smoke barrier system application
with toughened fire resistant safety glass

CLASSIFICATION

D₆₀₀ = temperature/time classification
for smoke barriers operating at 600° C
minimum temperature in conformance
with EN 12101-1 (Annex D)

SYSTEM DESCRIPTION

PYROSWISS® SBS (Smoke Barrier System)
controls the movement of fire and hot
smoke within buildings by forming a fixed,
transparent high temperature barrier.

TECHNICAL SPECIFICATIONS

System name

Fire resistance (EN 12101-1)

Application

Classification Report No.

Reaction to Fire (EN 13501-1)

CE certificate No. of conformity

PYROSWISS® SBS D 120

D₆₀₀ 120 classification

Static fixed smoke barrier

Efectis - France, EFR-17-000882

A1

0336-CPR-5064-E/06

TECHNICAL CHARACTERISTICS

Product Standard (Glass)

Nominal glass thickness

Thickness tolerance

Width and length tolerance

Impact resistance (EN 12600)

Transparence

Weight

Light transmission (EN 410)

EN 12150

6 mm

±0,2 mm

±2 mm

1(C)1 classification

Remains transparent in case of fire

15 kg/m²

89%

FIELD OF APPLICATION

Fire protection

Fittings / brackets

Supporting construction

Maximum tested glass size

Minimal dimensions

Number of holes per glass panel

Distance from hole to glass edge (W₁)

Maximum spacing between holes (W₂)

Gap at head (a to f)

Gap at edge (g)

Gap at intermediate joint (h)

bi-directional

Electro Galvanized steel or stainless steel

Concrete

2500 × 1800 mm (W × H)

Minimum production size

2 holes

100 mm ≤ W₁ ≤ 350 mm

1800 mm

10 mm

20 mm

5 mm

OPTIONS

consult with your Vetrotech representative

APPLICATIONS

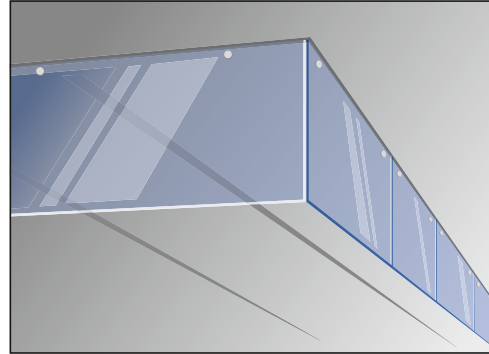

- smoke reservoir boundaries
- channeling screens
- corridor containment
- escalator containment
- stairwell containment
- elevator containment

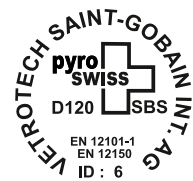

PYROSWISS® SBS D 120 (Smoke Barrier System)

Static smoke barrier system application
with toughened fire resistant safety glass

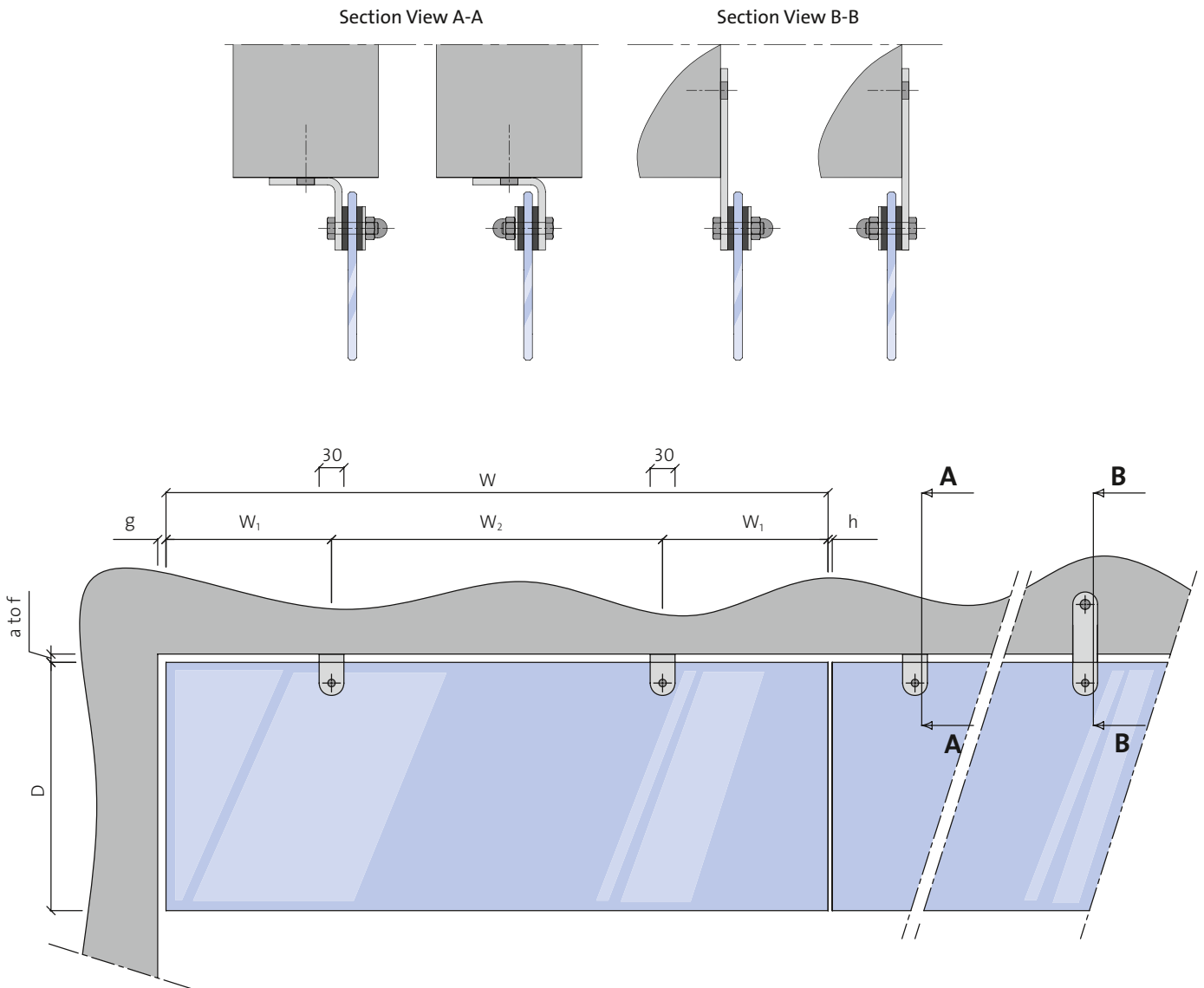

FIXING TYPES

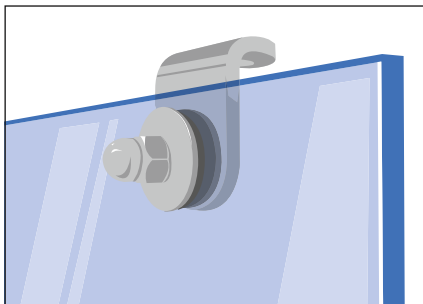

System «ECO»
Electrogalvanized steel fitting

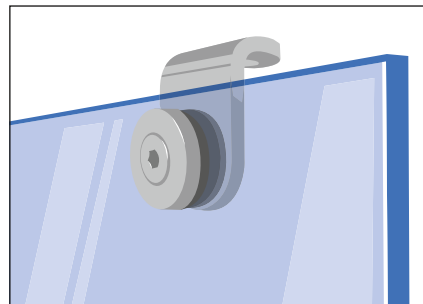

System «DESIGN»
Stainless steel fitting

W	≤ 2500 mm
D	≤ 1800 mm
W ₁	≥ 100 mm ≤ 350 mm
W ₂	≤ 1800 mm
a to f	10 mm
g	20 mm
h	5 mm

Installation guidelines

PYROSWISS® SBS (Smoke Barrier System)



1 Verify that the supporting construction is level.

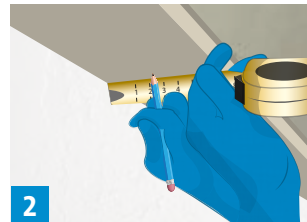

2 Locate the fixing points of the brackets on the supporting construction (concrete or lightweight partition).

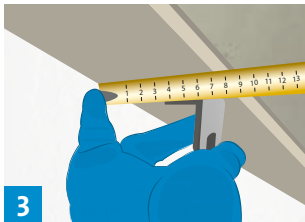
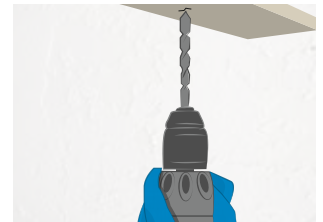

3 Check the alignment of the brackets.

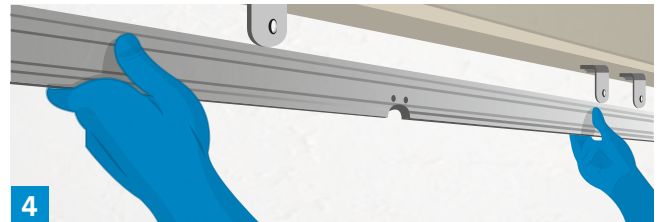
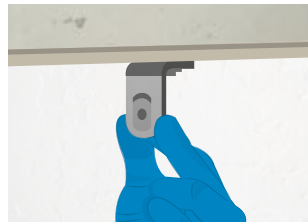

4 Verify that the brackets are level, shim as required.

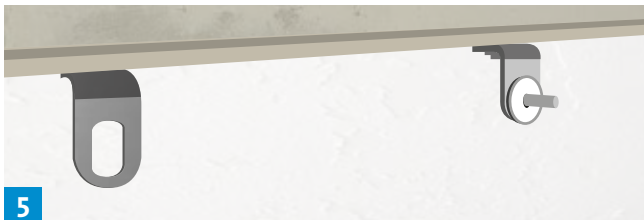

5 Prepare the brackets placing the intumescent washers onto the bolts (fasteners and washers are supplied with the kit).



6 Insert the grommets into the holes in the glass panels, then align over the fittings.



7 Holding the glass panel in place, assemble the outer intumescent washers and steel rings, then tighten securely (maximum force 15 N.m).



8 Verify perimeter gaps (a to f) and alignment of the glass panels, adjust as necessary.

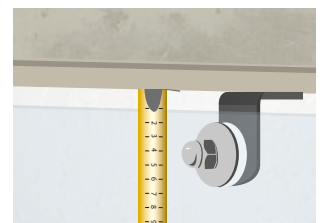

PYROSWISS® SBS D 120 (Smoke Barrier System)

Static smoke barrier system application
with toughened fire resistant safety glass



0336

Vetrotech Saint-Gobain International AG
Bernstrasse 43, CH-3175 Flamatt
10
0336-CPR-5064-E/06

EN 12101-1

Static smoke barrier, type SSB

Resistance to fire classification $D_{600} 120$
Response delay NPD

Opening, gaps and perimeter spaces:

Gap _{head} (a to f)	10 mm
Gap _{edge} (g)	20 mm
Gap _{joint} (h)	5 mm
Area _{head} = W × Gap _{head}	25000 mm ²
Area _{edge} = D × Gap _{edge}	36000 mm ²
Area _{joint} = D × Gap _{joint}	9000 mm ²
Area total = N1 × Area _{head} + N2 × Area _{edge} + N3 × Area _{joint}	
Maximum barrier permeability	NPD
Tested at ambient temperature	NPD

Two standard fitting options

SYSTEM «ECO»
Electro Galvanized Steel



SYSTEM «DESIGN»
Stainless Steel

